

USB CONNECTOR & CABLE ESB 0 SERIES (CONNECTOR)

■ FEATURES

- Both USB A Type and B Type are USB 2.0 approval.
- Raised design provides easy insertion and withdrawal, and guarantee even high reliability.
- Design of three certain restraints provides robust structure.
- Gold plated contact to ensure low contact resistance.
- All materials are UL 94V-0 grade fire retardant.
- Up to 5 meters per cable segment.
- To make sure your connections are perfect every time.

■ APPLICATIONS

- PCs peripheral equipment (modem, scanner, HDTV, printer, phone/answering, keyboard, mouse, game controller, digital audio)

■ SPECIFICATIONS

ELECTRICAL	
Voltage rating	30 VAC (rms)
Current rating	1 Amp
Contact resistance	30 mΩ Max.
Insulation resistance	1000 MΩ Min.
Dielectric strength	750 VAC Min.



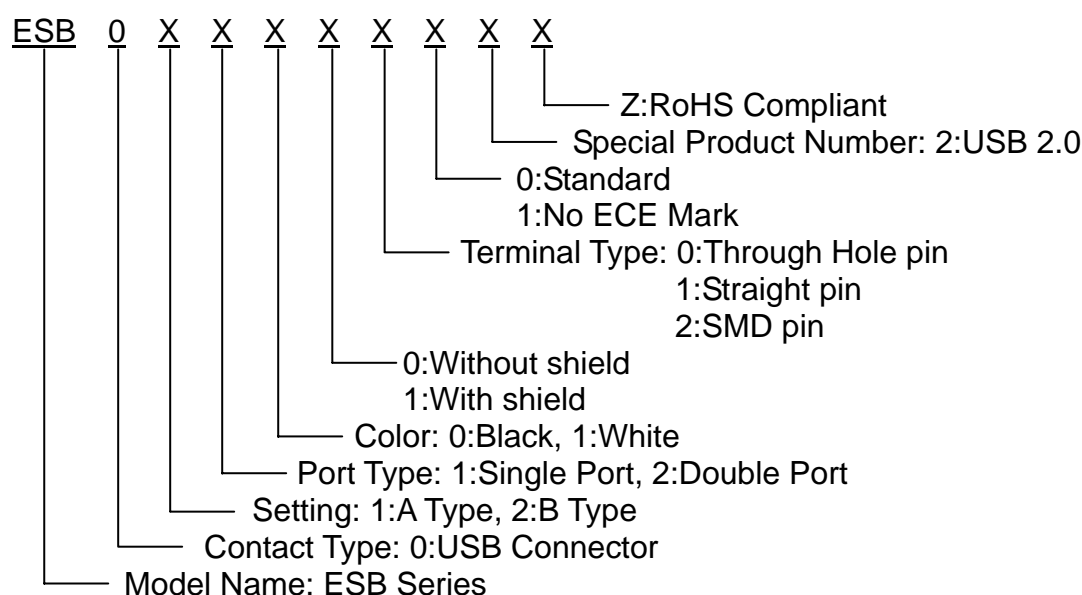

MECHANICAL	
Durability	1500 cycles
Mating force	35N Max.
Unmating force	10N Min.
Temperature	storage -40°C to + 60°C
	operating 0°C to + 40°C

■ PART NUMBERING SYSTEM

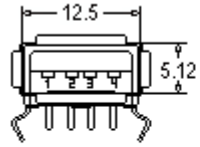
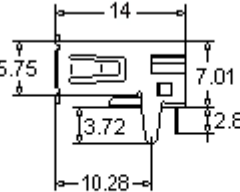
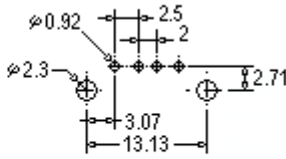

DIMENSIONS (UNIT:mm)

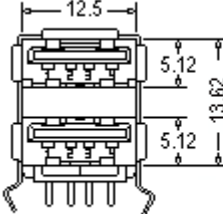
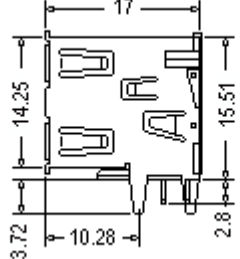
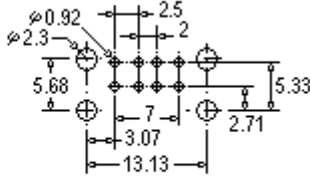
◆ RIGHT ANGLE TYPE

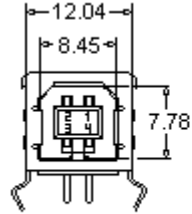
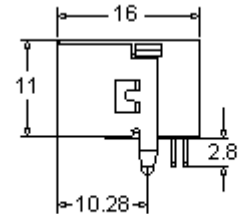
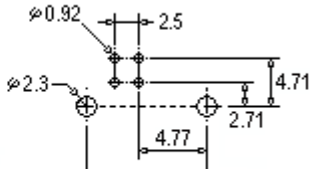
 <p>A TYPE Single port ESB 011</p>			 <p>P.C.B. Layout</p>
 <p>A TYPE Double port ESB 012</p>			 <p>P.C.B. Layout</p>
 <p>B TYPE ESB 021</p>			 <p>P.C.B. Layout</p>

◆ RIGHT ANGLE TYPE/WITH SHIELD

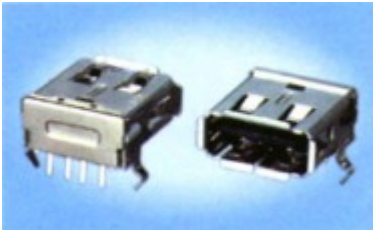
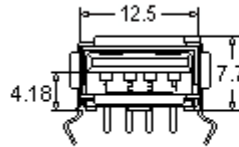
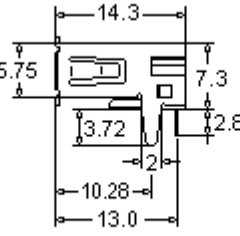
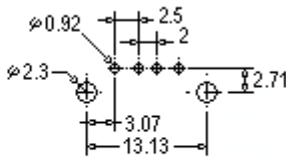
 <p>A TYPE Single port ESB 011x1</p>			 <p>P.C.B. Layout</p>
---	---	--	--

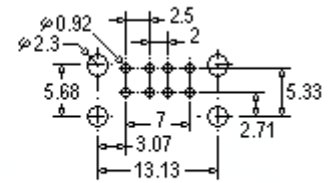
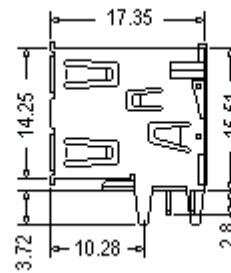
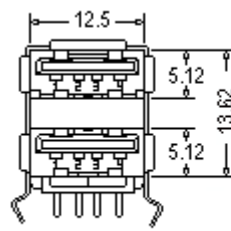

P.C.B. Layout

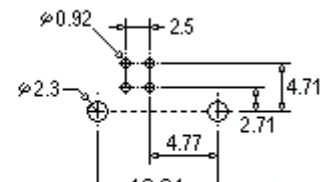
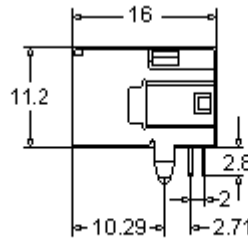
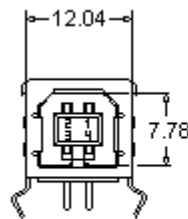

P.C.B. Layout

◆ STRAIGHT PIN TYPE

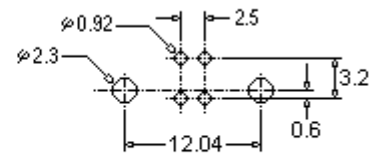
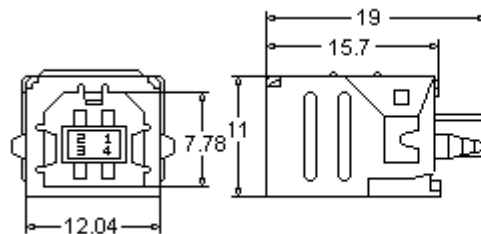

◆ SMD TYPE

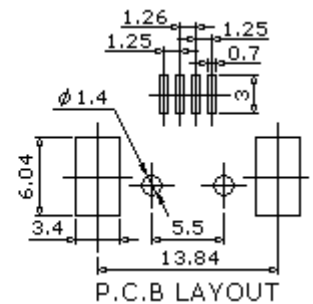
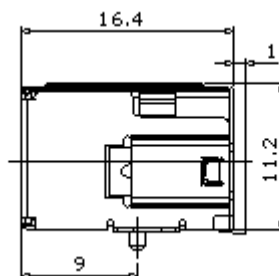
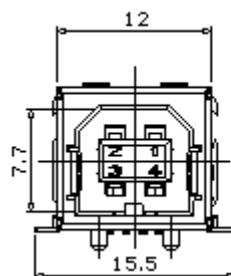

P.C.B. LAYOUT